

Link
tech

PREMIUM
VIP PRODUCT

Hello!

MODEL: LPH-TW38
TRUE WIRELESS EARHOOK
USER MANUAL

Please carefully read this Manual before using this Product for the very first time and well keep it for further reference.

Dear Link Tech User,

Thank you for choosing Link Tech product. Your choice is crucial for us, which means Link Tech has added a new user. Hope that we will bring you a good experience through our products and services. Also hope you will put forward the good advice and suggestions by official customer hotline, Whatsapp and Bp in the process of product experience, which can help Link Tech to constantly improve product and service.

If you encounter any problems in using this product, please refer to service process. Your support is our strongest power, also your recognition and evaluation are a great encouragement to Link Tech. Thank you!

Link Tech Sales Team

TRUE WIRELESS EARPHONES



Product Structure

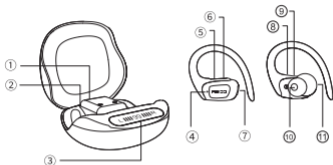

1- Type-C charging interface

3- Charging box digital display

5- Left ear volume decrease

7- Left ear multi -function key

9- Right ear volume increase

11- Right ear multi -function key

2- Charging box button

4- Earbud indicator light

6- Left ear volume increase

8- Right ear volume decrease

10- Earbud speaker

Technical Specifications

Wireless Version	V5.3
Transmission Range	10m
Charging Box Capacity	400mAh
Earphone Capacity	50mAh
Charging Port	Type-C
Charging Voltage	DC 5V
Music Time	Around 6hrs(80% volume)
Talk Time	Around 3.5hrs(80% volume)
Charging Time	Around 1.5hrs

Wireless pairing

1. Open the charging compartment and remove the earbuds. The earbuds will automatically turn on or press and hold the multifunction button for 2 seconds, and the indicator light for the earbuds will light up.
2. After connecting the earbuds of the device, it will automatically enter pairing mode upon startup (and try to connect back to the last connected phone); Open the wireless interface of the phone, search for "Link-TW38" and click pairing. The connection is successful and accompanied by a prompt tone.

Power on / off

Power on: Open the charging compartment, take out the earbuds, the earbuds will automatically turn on, and the earbuds will automatically pair and wait for connection.

Press and hold the multifunction button for 2 seconds to turn on the device.

Shut down: Place the L/R earbuds into the charging compartment, close the cover, turn off the earbuds and start charging (any L/R)

Press and hold the multifunction button for 5 seconds to turn off the devices. When the earbuds are turned on and the device is not connected, they will automatically turn off after 5 minutes.

Call usage

When using the call function, the L / R earbud can perform the following operations:

Answer: click the multi-function touch key.

Hang up: click the multi-function touch key.

Reject: press and hold the multi-function key touch area for 2 seconds

Wake up voice assistant function (if your phone support this function)

In the music playing or pause state, triple-click the multi-function touch key to start or close the voice assistant function (Siri).

Music use

Music pause / play: click the left/right ear multi-function touch area (left ear L/right ear R).

Previous song: when music is playing, press and hold the left ear multifunction button for 2 seconds (left ear L).

Next song: when music is playing, press and hold the right ear multifunction button for 2 seconds (right ear R).

Volume up: when music is playing, click the left/right ear volume + button (left ear L/right ear R).

Volume down: when music is playing, click the left/right ear volume - button (left ear L/right ear R).

Charging indicator light

1. Charge the charging case by cable

When charge the charging case: The digital LED display of the charging case displays 100.
When charging case charged fully: The digital LED displays 100.

2. When put the earphone into the charging case, they will be charged automatically. The digital LED displays "L", left earphone on the charging, and extinguish when charging fully. The digital LED displays "R", right earphone on the charging, and extinguish when charging fully.

3. Charging case button: When the earphones in the charging case, click the button once to display the power of the charging case. Long press the charging case button for six seconds to restore the factory setting, please delete BT pairing information before restoring the factory settings.

Attention

1. The main ear serves as a bridge between the secondary phone and the mobile phone without interruption, and it is normal for the power consumption to be better than that of the secondary unit.
2. iPhone displays the battery power in real time.
3. Wearing method is very important to avoid the signal antenna blocked by the inside of the ear, please wear according to the introduction page wearing method.
4. In the binaural mode, any one-side earphone will block a signal by hand. Currently, this type of technology earphone has this situation, because The equivalent of blocking the signal connection between the two earphones by hand.
5. In the binaural mode, it is not allowed to have too many disturbing obstacles between earphone and main earphone (earphone R), and ensure both the distance between them won't effect signal transmission.
6. In binaural mode, if the secondary earphone (L earphone) has an occasional disconnection problem It is a normal phenomenon, after all, wireless is a wireless signal transmission, Like the WiFi network, sometimes instability is normal. At this point, just the signal transmission is disturbed, please wait a moment or move to another place.

Warning

- Do not use corrosive cleaners to clean the product.
- Do not allow this product to be heated or near a fire source.
- Do not expose the product to direct sunlight for a long time.
- Do not discard the product in the fire to avoid explosion.
- Do not make any modifications to try to disassemble this product because it does not contain any modifiable components.
- Do not use this product in the rain.
- If you do not use this product for a long time, please store it in a dry environment and charge the headset at least once a month to prolong its service life and avoid extreme temperature and dust.
- You must choose a regular charger from a qualified manufacturer to charge the earphone. This device complies with Part 15 of FCC Rules. Operation is subject to the following two conditions: (1) This device may not cause harmful interference, and (2) This device must accept any interference received, including interference that may cause undesired operation.

FAQ

Earphones cannot be used normally	Put the earphone into the charging box, delete the wireless pairing name in the mobile phone and turn off the wireless function; after 5 seconds, reopen the battery compartment cover to connect the earphone.
No sound out from earphone	<ol style="list-style-type: none">1. Check the wireless device and the current volume of the earphone, make sure it sets on proper volume.2. Make sure the earphone pairing to the correct device.3. Keep your earphone and wireless device in the effective distance within 10 meters.4. Make sure your wireless audio output is on.
Earphone disconnection	<ol style="list-style-type: none">1. Check the earphone if it searching or pairing. Select the correct device, or try to restart it.2. If there are multiple wireless device around, please turn them off to avoid connecting interference.3. If the earphone has been connected with other device, please disconnect it firstly, restart and try it again.4. If the earphone is low power, charge it.
Sound distortion and sound broken	<ol style="list-style-type: none">1. The quality of the audio file of the device is poor, change it to high quality audio file.2. Check the volume level and reduce it if necessary.3. Check whether the device is out of power, charge it firstly.4. The distance between the earphone and device is beyond the effective distance, or there is obstacle between them.
Wireless connected keyboard unavailable	Please click the exclamation point on the right side of the wireless connection. Turn off the input device connection.

